

**NeverStrip™**  
FLOOR COATINGS

# NeverStrip Matte™



# NeverStrip Matte™

## Characteristics

- High performance, clear, 2-part, water-based, aliphatic (non yellowing) urethane floor coating.
- Matte gloss reading @ 60 degree angle.
- VOCs less than 100 g/l.
- In-use time of 8-12 hrs at 77°F and 50% RH for light foot and cart traffic (affected by air flow, temperature and humidity).
- Applied to resilient and non-resilient flooring surfaces including wood, VCT, LVT, and concrete.
- Low odor-Non offending.
- Strong resistance to chemicals, abrasions and scratches.
- Interior use only.
- Vertical or horizontal surfaces
- Typical coverage of 350 to 400 sq ft per gallon, may be less or more depending on flooring porosity.
- Volume solids: 43%
- Does not need to be removed for recoats.
- Resistant to salt, urine, coffee, wine, cola, orange juice, disinfectants and many cleaners.
- Meets slip coefficient guidelines.
- Slip coefficient can be enhanced with NeverStrip Grip Aggregates or NeverStrip Liquid Grip as a topcoat.
- Resistant to many alcohol based sanitizers.
- Unopened can shelf life is 365 days from manufacture.

## Surface Preparation

### General

Remove any floor finish, soil, sealers, etc. Verify 7-8 pH and tack the floor with microfiber flat pad and/or 3M Easy Trap Duster to remove hair, lint, etc. Dry vacuuming is a recommended floor preparation method.

### Concrete

All concrete substrates must be solid, thoroughly clean and free of oil, wax, grease, asphalt, latex, gypsum and curing compounds, sealers and any contaminant that might act as a bond breaker. Mechanically clean the floor to a sound, solid concrete by shot blasting, scarifying or equivalent manner to achieve 100 to 200 grit profile.

### Wood

- 1 Sand and prepare floor using accepted industry methods.
- 2 For a stained floor, make final cut with 80-100 grit paper and disc/screen to 80-100 grit. For an unstained floor, make final cut with 80-100 grit paper and disc/screen to 120-150 grit. This burnishing will reduce the amount of grain raise.
- 3 Use a Tampico Brush on a buffer and vacuum thoroughly.
- 4 Tack with a dry microfiber mop or cloth to remove dust.
- 5 Apply finish system which generally incorporates a two coat application of a high quality wood sealer using the recommended procedures of the wood sealer manufacturer; followed by one or two coat application of NeverStrip Matte, depending on customer preference.

### Terrazzo

Hone to 100-200 grit profile

### Existing Coatings

Abrade with an appropriate sanding screen/pad. Do not apply onto peeling or loose surfaces.

### Second Coats or Recoats

If within 24 hours, then next coat may be applied without abrasion; after 24 hours, lightly abrade with a maroon conditioning pad; after 7 days, then clean with green scrubbing pad and Profi Cleaner by Taski; lightly abrade with 120 grit sanding screen, clean and tack.

**Protect adjacent surfaces with tape and appropriate materials.**

# NeverStrip Matte

## CAUTION

- Appearance and adhesion should be verified in a small area prior to full-scale application of the coating on a commercial floor.
- Use the product within 12 months of manufacture date.
- Do not put more than two gallons in an application tub or container at one time.
- Verify alcohol-based hand sanitizers used in the facility and their affect on the coating before widespread usage.
- **DO NOT APPLY TAPE** to the coating. If tape must be applied, only use light adhesive tape such as 3M's Delicate Surface Tape (2080), after testing in an out of the way area.
- **READ AND FOLLOW** the product SDS for safety and handling information.

## Mixing and Application

- 1 Drill Part A with slow speed drill for 10 seconds
- 2 Pour Part A and Part B into a larger container (4:1 Ratio)
- 3 Drill Part A and Part B with a slow speed drill for 3 minutes
- 4 Pour the entire contents into a 7-10 gallon application tub to apply the coating. Product is best applied with a Dip and Roll Method.
- 5 **Apply Product within 30 Minutes for Best Results.**
- 6 Apply product with high quality, non-shed 6", 9" or 18"-3/8" nap microfiber or 3/8" nap woven roller cover from NeverStrip. Use a small brush for tight spots.
- 7 Application should be done with room and floor surface temperatures of 60°F and 80°F. The coatings should not be applied if the relative humidity is 80% or higher in the space to be coated.
- 8 NeverStrip further recommends the use of a temperature and humidity gauge at the project.
- 9 Change application tubs and rollers every 30 minutes.
- 10 Apply product over wet edges within 3-5 minutes.
- 11 Turn HVAC units to 72°-75°F before and during application and block cold air from blowing directly onto the coating during the drying period.
- 12 Keep indoor doors open during the drying process to insure an even airflow. Push/pull air out of rooms to aid drying. Standard inexpensive box fans provide an even desirable airflow. The use of fans is critical in small confined spaces, such as restrooms.
- 13 **DO NOT** allow stagnant air during drying, especially in more humid and higher temperature conditions and smaller spaces such as restrooms.



# NeverStrip Matte

## Cleaning/Maintenance

- Clean as needed
- Clean with a microfiber mop/flat pad and clean water.
- For high soil and high demand environments, periodically allow cleaning solution to reside on floor for 10-15 minutes before removal.
- For best results, clean with an auto scrubber or 175 rpm floor machine with squeegee wet vac and white pad or brush equivalent.

- **DO NOT BURNISH**
- **DO NOT DRY SCRUB**
- **DO NOT USE GREEN PAD OR MORE AGGRESSIVE PAD TO CLEAN THE FLOOR**
- **DO NOT USE RED PAD WITHOUT WATER ON THE FLOOR**

- Use proper matting to keep dirt and grit off of the floor.
- If a haze develops on the coating, then periodically clean with water and alkaline cleaner to remove any excess cleaner build-up.
- Do not allow standing water to reside on the coating for prolonged periods of time and do not allow saturated mats that do not dry out to be on the coating for extended periods of time.
- Use a white pad equivalent brush when cleaning a coating with NeverStrip Grip Aggregate or NeverStrip Liquid Grip.
- Maintain appropriate NeverStrip supplied glides to prevent scratching from chairs, tables and moveable furniture fixtures.
- Refer to [www.NeverStrip.com](http://www.NeverStrip.com) for complete Cleaning and Maintenance Guidelines.

## Removal

- The coating should not need to be removed in its normal life cycle.
- Removal in small areas is best done using a water-based stripper from NeverStrip called Dorado 3032.
- Removal in large areas may not be practical.
- On floors where one can use belt-sanding machines or an oscillating machine like a Square Scrub or equivalent, then this approach may aid removal of the coating (wood, concrete, stone, and terrazzo).



# NeverStrip Matte

## Mixing Instructions

Please refer to  
NeverStrip Product Information  
for extended instructions.

For NeverStrip Authorized Dealer  
Professional Use Only.

DRILL Part A slow speed for 10 seconds

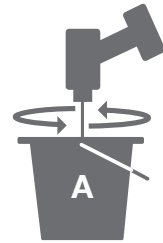

POUR Part A and Part B into container  
**NO Part C, DO NOT ADD WATER!**

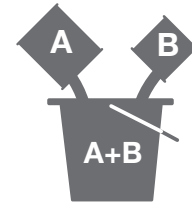

DRILL slow speed for 3 minutes



AFTER mixing, pour into a  
7-10 gallon application tub

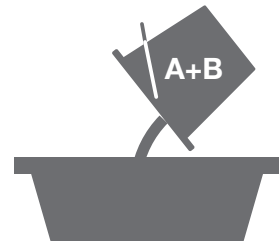

APPLY within 30 minutes



**NeverStrip**  
FLOOR COATINGS

800.854.5414  
orders@neverstrip.com  
www.neverstrip.com

**For Hazardous Materials (or Dangerous Goods) Incident:**  
Spill, Leak, Fire, Exposure, or Accident  
Call CHEMTREC, Day or Night USA and Canada  
800.424.9300

**DO NOT STORE ABOVE 90°F OR TRANSPORT ABOVE 120°F**

**DO NOT MIX IF PRODUCT TEMPERATURE IS ABOVE 75°F**

**DO NOT APPLY IF AMBIENT TEMP IS BELOW 60°F OR ABOVE 80°F**

**AVOID FREEZING**

**FOR NEVERSTRIP TRAINED PROFESSIONAL USE ONLY  
READ ALL PRECAUTIONARY INFORMATION FIRST**