

NeverStrip™
FLOOR COATINGS

NeverStrip Satin™



NeverStrip Satin

Characteristics

- High performance, clear, 2-part, water-based, aliphatic (non yellowing) urethane floor coating.
- Commercial applications generally are recoated every 1-5 years depending on conditions.
- Approximate 60-70 gloss reading @ 60 degree angle.
- VOCs less than 100 g/l
- In-use time for light foot and cart traffic of 8-12 hours (affected by air flow, temperature and humidity).
- Applied to resilient and non-resilient flooring surfaces.
- Low odor
- Good resistance to chemicals, abrasions and scratches.
- Interior use only
- Vertical or horizontal surfaces
- Coverage of 300 to 400 sq ft gal (depending on porosity of surface).
- Volume solids: 43%
- Does not need to be removed for re coats
- Resistant to salt, urine, coffee, wine, cola, orange juice, disinfectants and many cleaners.
- Meets slip coefficient guidelines
- Slip coefficient can be enhanced with NeverStrip Grip Aggregates or NeverStrip Liquid Grip as a topcoat.
- Resistant to many alcohol based sanitizers.
- Shelf life is 365 days from manufacture.

Surface Preparation

General: Remove any floor finish, soil, sealers, etc. Verify 7-8 pH and tack the floor with microfiber flat pad and/or 3M Easy Trap Duster to remove hair, lint, etc. Dry vacuuming is a recommended floor preparation method.

Concrete: All concrete substrates must be solid, thoroughly clean and free of oil, wax, grease, asphalt, latex, gypsum and curing compounds, sealers and any contaminant that might act as a bond breaker. Mechanically clean the floor to a sound, solid concrete by shot blasting, scarifying or equivalent manner to achieve 100 to 200 grit profile.

Terrazzo: Hone to 100-200 grit profile

Existing Coatings: Abrade with an appropriate sanding screen/pad. Do not apply onto peeling or loose surfaces.

Second Coats or Recoats: If within 24 hours, then next coat may be applied without abrasion; after 24 hours, lightly abrade with a maroon conditioning pad; after 7 days, then clean with green scrubbing pad and Profi Cleaner by Taski; lightly abrade with 120 grit sanding screen, clean and tack.

Protect adjacent surfaces with tape and appropriate materials



NeverStrip Satin

CAUTION

- Appearance and adhesion should be verified in a small area prior to full scale application of the coating on a commercial floor.
- Use the product within 12 months of manufacturing date.
- Do not put more than two gallons in an application tub or container at one time.
- Do not mix if the product temperature is over 75°F.
- **DO NOT PUDDLE THE PRODUCT**
- Verify alcohol-based hand sanitizers used in the facility and their affect on the coating before widespread usage.
- **DO NOT APPLY TAPE to the coating.** if tape must be applied, only use light adhesive tape such as 3M's Delicate Surface Tape (2080), after testing in an out of the way area.
- Prior to application insure the concretes Relative Humidity (RH) is below 80%.
- If the Relative Humidity is 80% or higher, then a moisture mitigation/waterproofing system is recommended.
- **READ AND FOLLOW** the products MSDS for safety and handling information.

Mixing and Application

- 1 Drill Part A with slow speed drill for 10 seconds
- 2 Pour Part A and Part B into a larger container (4:1 Ratio)
- 3 Drill Part A and Part B with a slow speed drill for 3 minutes
No Part C; DO NOT ADD WATER
- 4 Pour the entire contents into a 7-10 gallon application tub to apply the coating. Product is best applied with a Dip and Roll Method.
- 5 **APPLY PRODUCT WITHIN 30 MINUTES FOR BEST RESULTS**
- 6 Apply product with high quality, non-shed 6", 9" or 18" - 3/8" nap microfiber or 3/8" nap woven roller cover from NeverStrip. Use a small brush for tight spots.
- 7 Application should be done with room and floor surface temperatures of 60°F and 80°F. The coatings should not be applied if the relative humidity is 80% or higher in the space to be coated. Product temperature should not exceed 75°F at application.
- 8 NeverStrip further recommends the use of a temperature and humidity gauge at the project.
- 9 Change application tubs and rollers every 45 minutes. Apply product over wet edges within 3-5 minutes. Turn HVAC units to 72°-75°F before and during application and block cold air from blowing directly onto the coating.
- 10 Maintain added airflow from box fans positioned off the floor. Keep indoor doors open during the drying process to insure an even airflow. Push/pull air out of rooms to aid drying. Standard inexpensive box fans provide an even desirable air flow. One box fan for every 400 feet is ideal. The use of fans is critical in small spaces such as restrooms.
- 11 **DO NOT** allow stagnant air during drying, especially in more humid and higher temperature conditions and smaller spaces such as restrooms spaces such as restrooms.



NeverStrip Satin

Cleaning/Maintenance

- Clean as needed
- Clean with a microfiber mop/flat pad and clean water.
- For high soil and high demand environments, periodically allow cleaning solution to reside on floor for 10-15 minutes before removal.
- For best results, clean with an auto scrubber or 175 rpm floor machine with squeegee wet vac and white pad or brush equivalent.

- **DO NOT BURNISH**
- **DO NOT DRY SCRUB**
- **DO NOT USE GREEN PAD OR MORE AGGRESSIVE PAD TO CLEAN THE FLOOR**
- **DO NOT USE RED PAD WITHOUT WATER ON THE FLOOR**

- Use proper matting to keep dirt and grit off of the floor.
- If a haze develops on the coating, then periodically clean with water and alkaline cleaner to remove any excess cleaner build-up.
- Do not allow standing water to reside on the coating for prolonged periods of time and do not allow saturated mats that do not dry out to be on the coating for extended periods of time.
- Use a white pad equivalent brush when cleaning a coating with NeverStrip Grip Aggregate or NeverStrip Liquid Grip.
- Maintain appropriate NeverStrip supplied glides to prevent scratching from chairs, tables and moveable furniture fixtures.
- Refer to www.NeverStrip.com for complete Cleaning and Maintenance Guidelines.

Removal

- The coating should not need to be removed in its normal life cycle.
- Removal in small areas is best done using a water-based stripper from NeverStrip called Dorado 3032.
- Removal in large areas may not be practical.
- On floors where one can use belt-sanding machines or an oscillating machine like a Square Scrub or equivalent, then this approach may aid removal of the coating (wood, concrete, stone, and terrazzo).



NeverStrip Satin

Mixing Instructions

Please refer to
NeverStrip Product Information
for extended instructions.

For NeverStrip Authorized Dealer
Professional Use Only.

DRILL Part A slow speed for 10 seconds

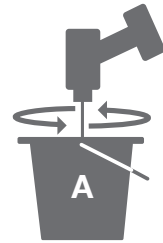

POUR Part A and Part B into container
NO Part C, DO NOT ADD WATER!

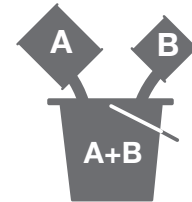

DRILL slow speed for 3 minutes



AFTER mixing, pour into a
7-10 gallon application tub

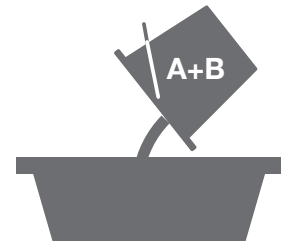

APPLY within 30 minutes



NeverStrip
FLOOR COATINGS

800.854.5414
orders@neverstrip.com
www.neverstrip.com

For Hazardous Materials (or Dangerous Goods) Incident:
Spill, Leak, Fire, Exposure, or Accident
Call CHEMTREC, Day or Night USA and Canada
800.424.9300

DO NOT STORE ABOVE 90°F OR TRANSPORT ABOVE 120°F

DO NOT MIX IF PRODUCT TEMPERATURE IS ABOVE 75°F

DO NOT APPLY IF AMBIENT TEMP IS BELOW 60°F OR ABOVE 80°F

AVOID FREEZING

**FOR NEVERSTRIP TRAINED PROFESSIONAL USE ONLY
READ ALL PRECAUTIONARY INFORMATION FIRST**